

CALLE - 6

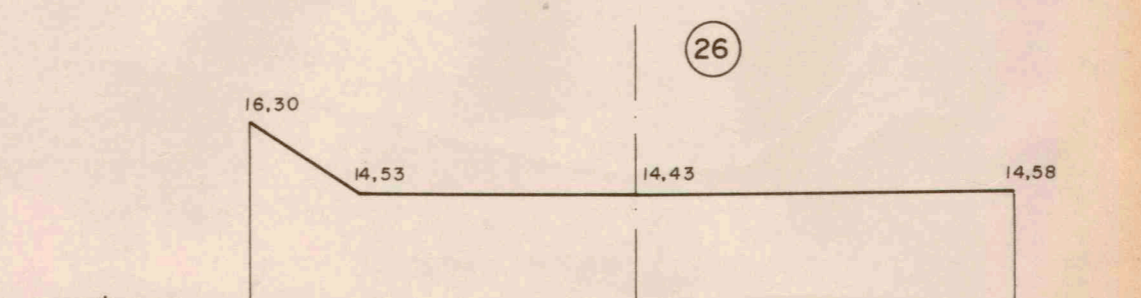
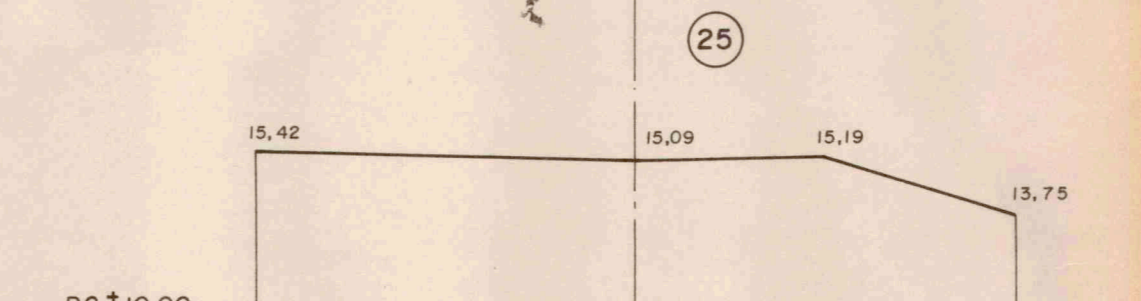
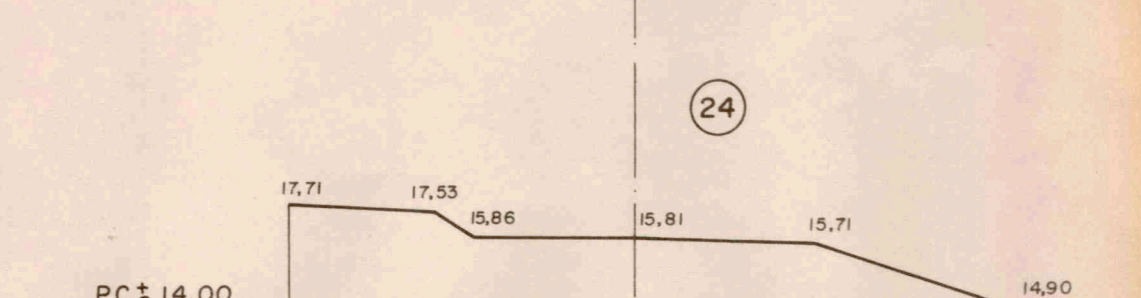
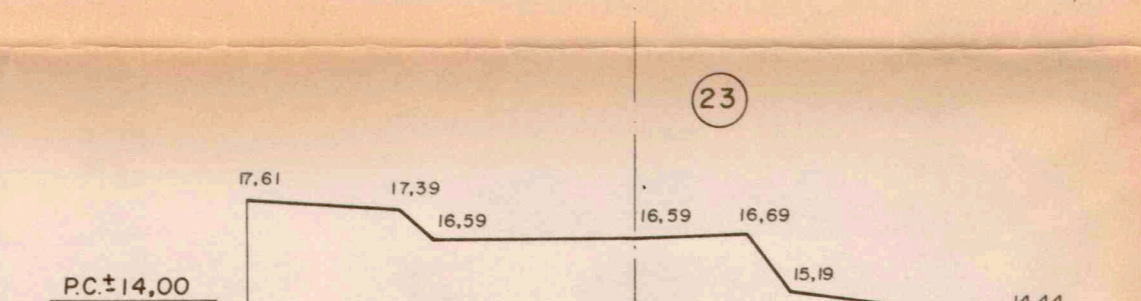
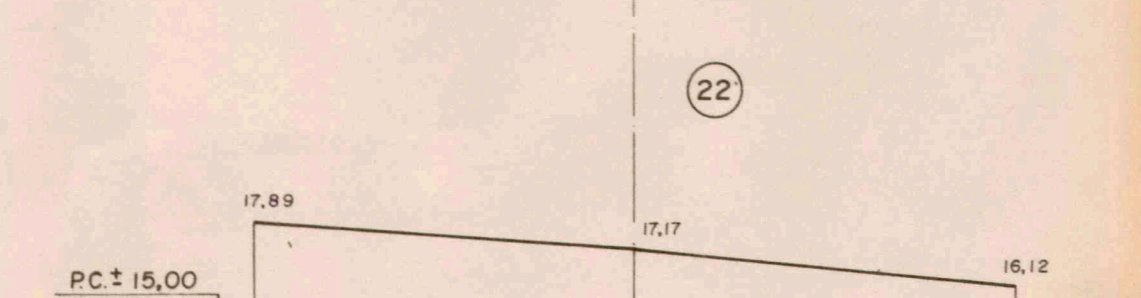
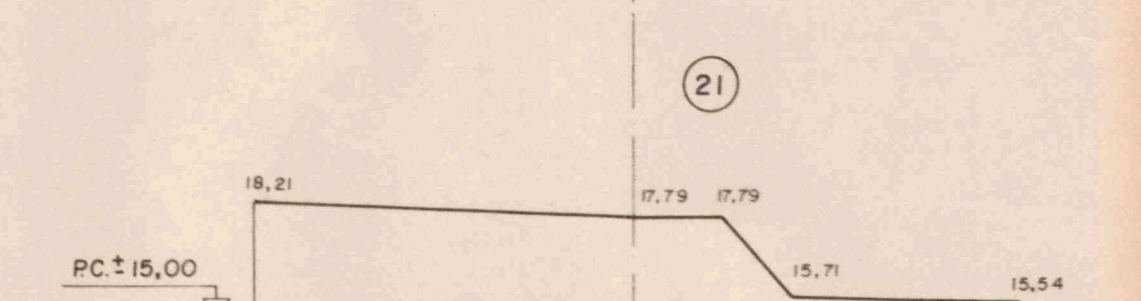
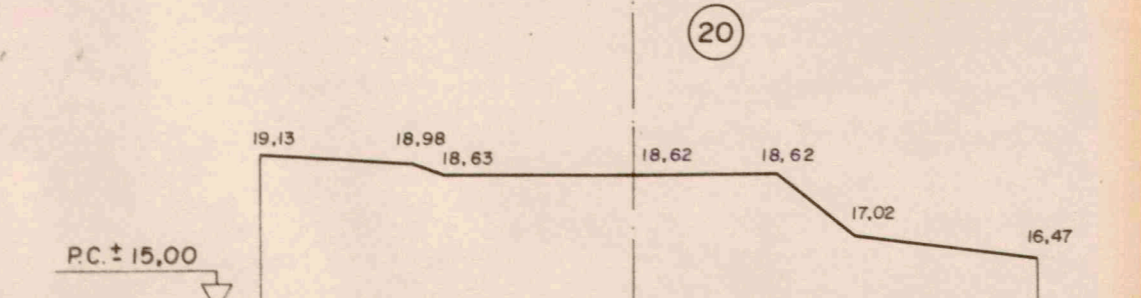
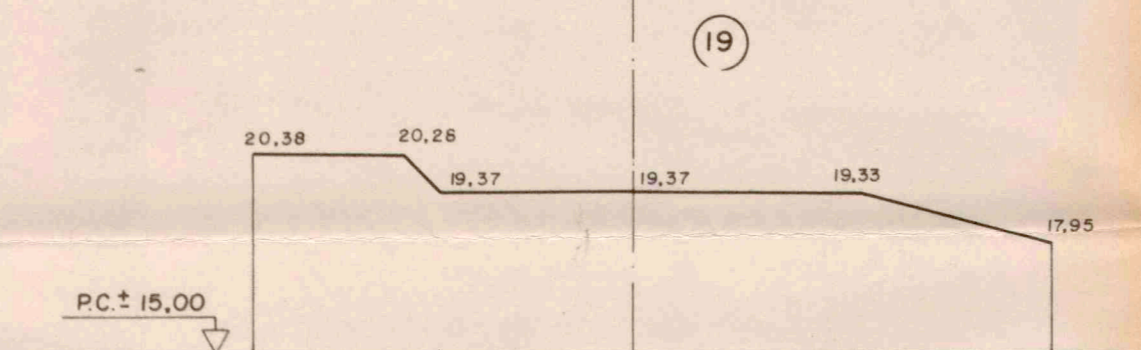
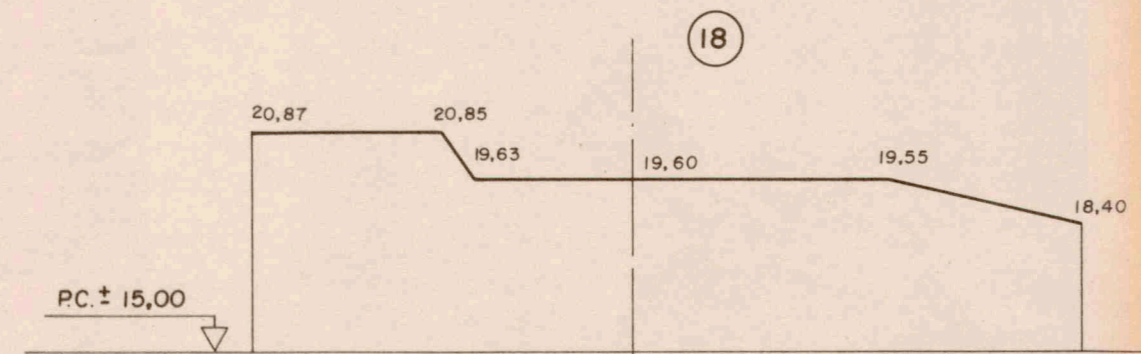
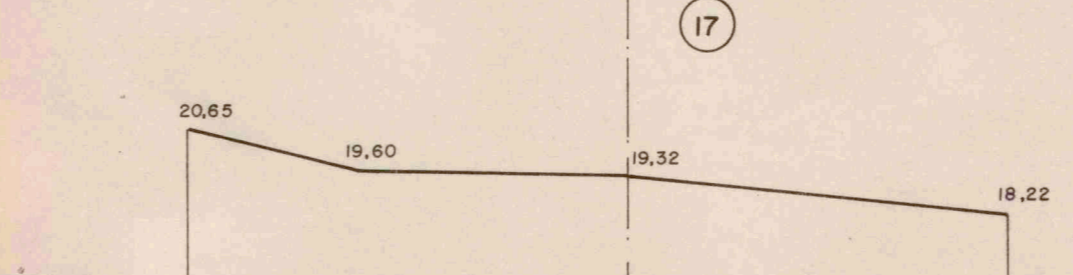
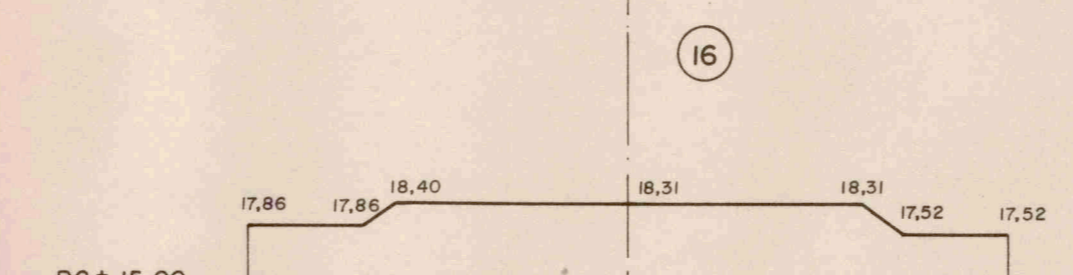
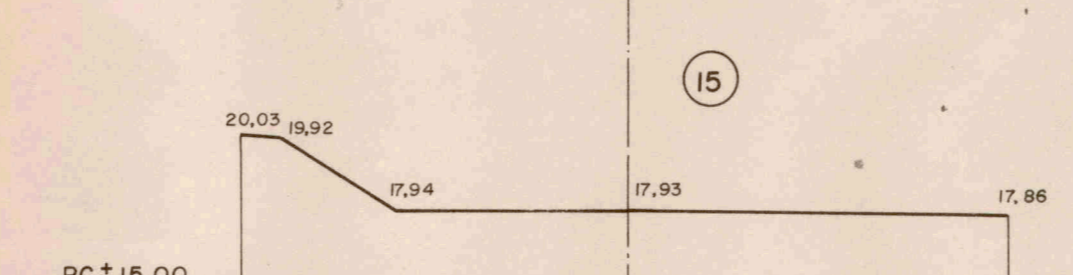
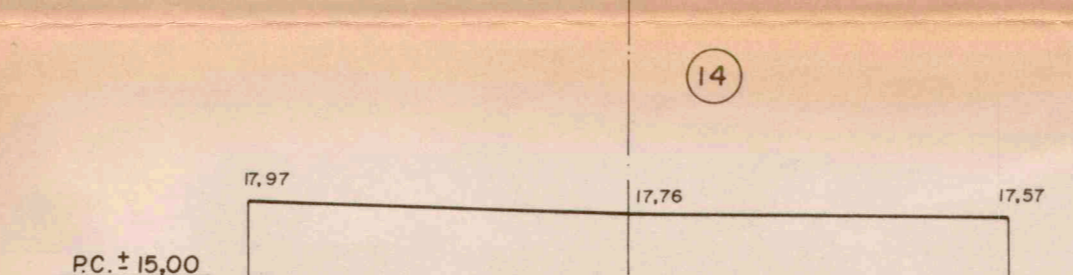
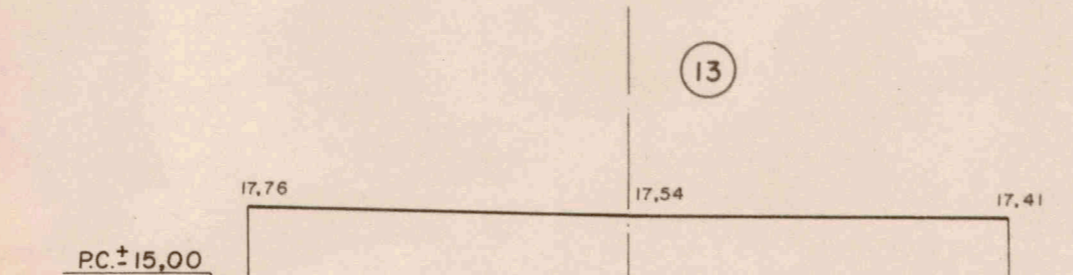
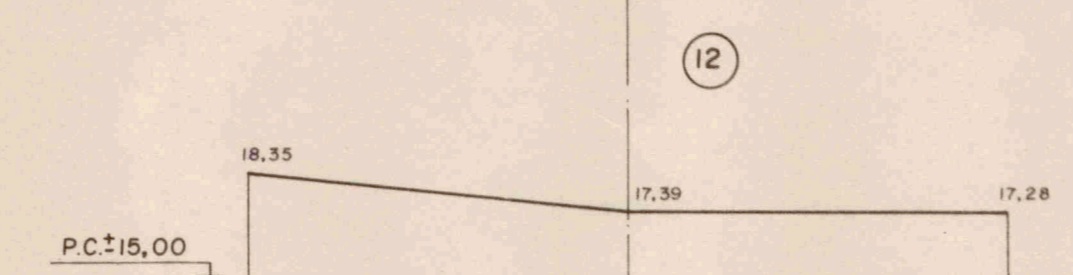
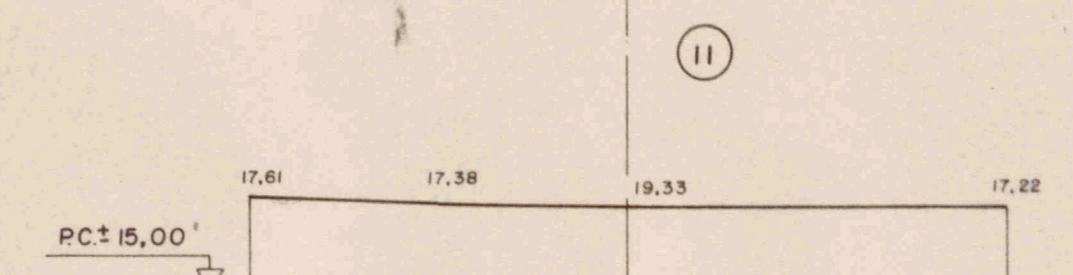
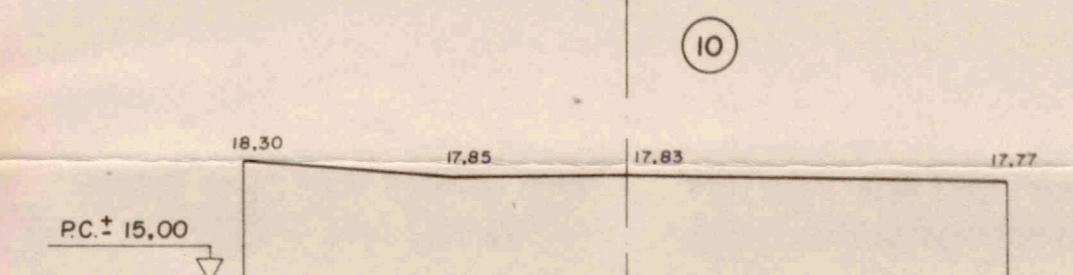
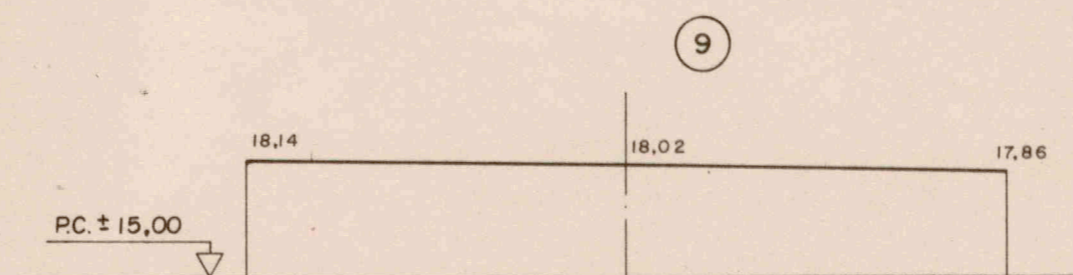
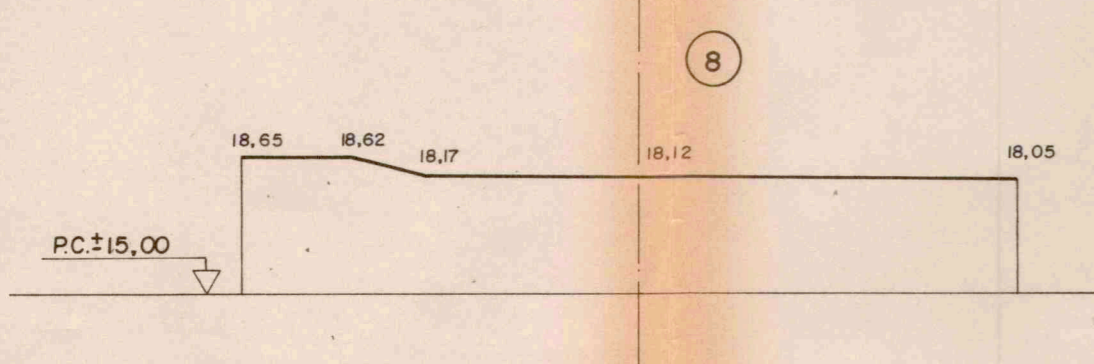
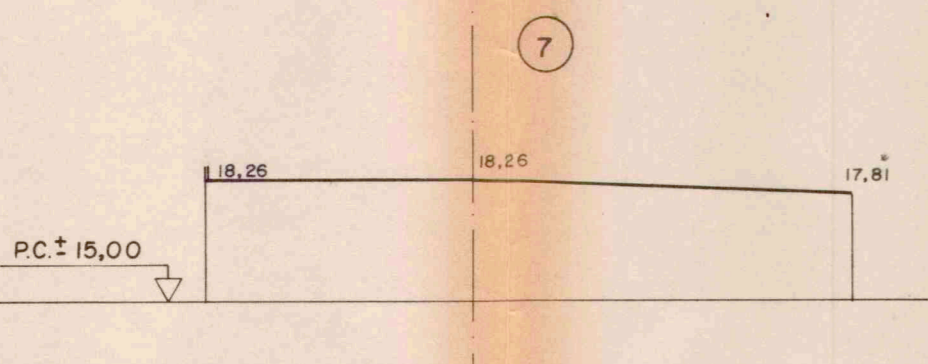
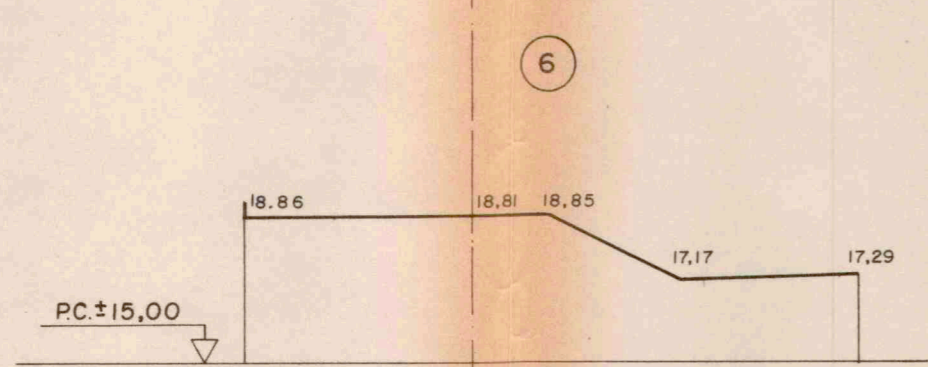
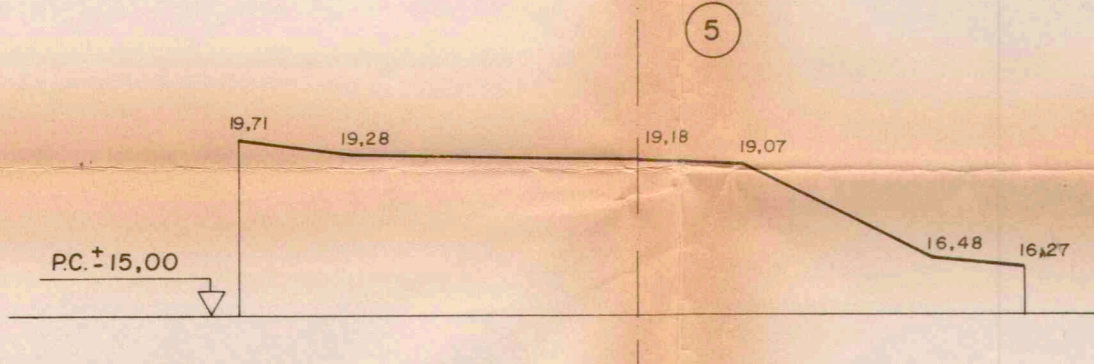
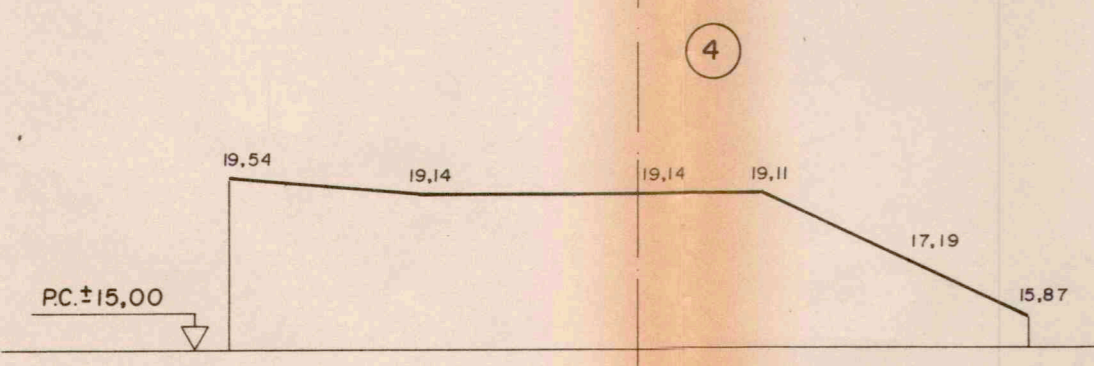
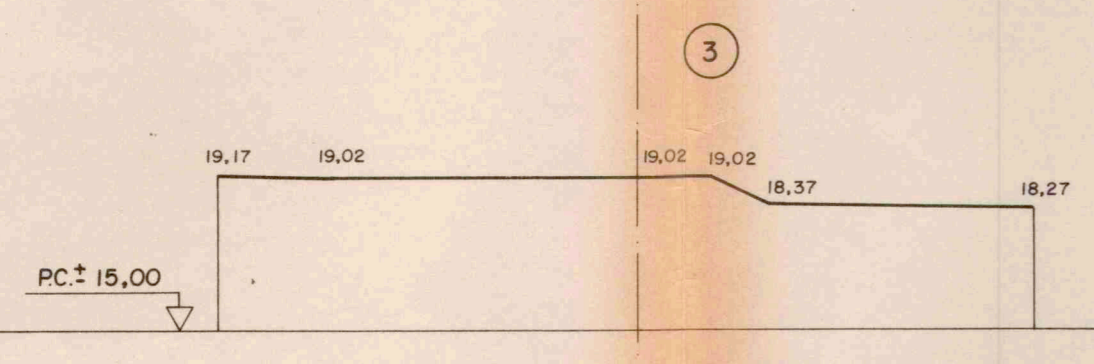
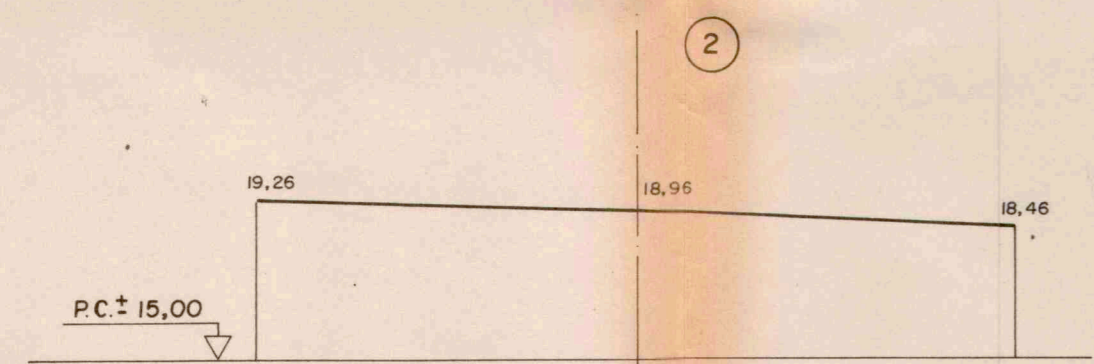
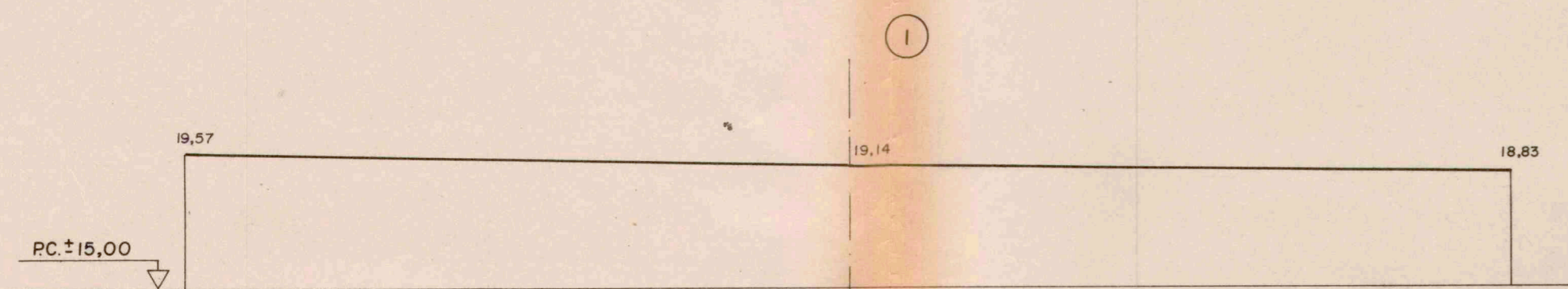

Escalas Horizontal : 1/200
Vertical : 1/200

El Secretario de la Comisión,
Las Palmas de G.C. 13 OCT. 1992
sentó exparte.
APROBACIÓN DEFINITIVA del pre-
fecha 1 JUN. 1988
Ambiente de Canarias, en sesión de
La Comisión de Urbanismo, Medio

2.3.I.II

F/312/87

COLEGIO OFICIAL DE ARQUITECTOS
DE CANARIAS
DELEGACION DE LAS PALMAS
17 FEB. 1987
VISTO a los efectos Reglamentarios

PERFILES TRANSVERSALES CALLE 6 E.H=1/500
E.V=1/50

DILIGENCIA: La pongoy, el Secretario,
para hacer constar que el presente do-
cumento fue aprobado en sesión de
sesión de fecha 14 FEB. 1987
La Oliva de Fuerteventura, de 1.987
El Secretario,

LA PRODIGENCIA: La pongoy, el Secretario,
para hacer constar que el presente do-
cumento fue aprobado en sesión de
sesión de fecha 26 FEB. 1988
La Oliva de Fuerteventura, de 1.988
El Secretario,

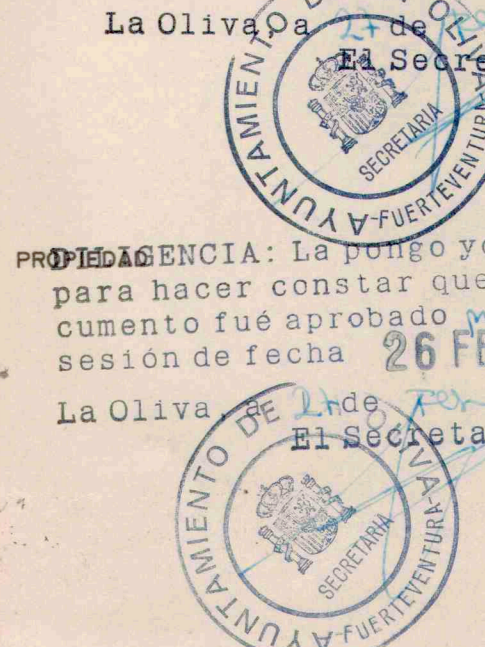

REVISIÓN DEL PLAN PARCIAL DE ORDENACION Y
EXPANSION DE CORRALEJO PLAYA, SITO EN EL T.M.
DE LA OLIVA FUERTEVENTURA, PROPIEDAD DE PROCOSA
DETUCCA Y OTROS.